



## RIV 4601

Ball valve with compression ends  
 for copper pipe  
 full bore  
 blue steel lever handle

### Tech drawings and tables

DN	Code	Ø	H	S	L	B	KG	P/box
15	024601000035	14,5	48	55	80	71	0,217	10
22	024601000041	19	55	65,5	105	83,5	0,351	10
28	024601000026	24	60	71	105	91	0,500	10

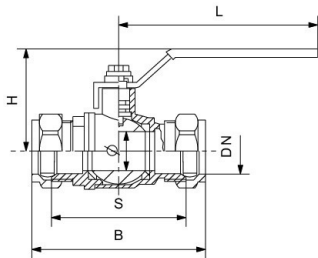

## Technical data

Art. 4170

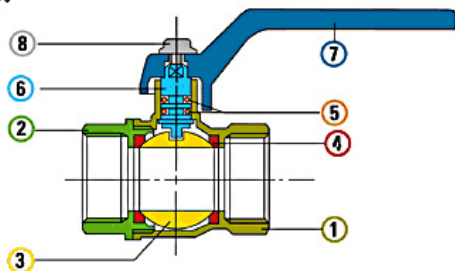

### Materials

1	Body	Brass	CW617N	Nickel-plated
2	Body end	Brass	CW617N	Nickel-plated
3	Ball	Brass	CW617N	Chrome-plated
4	Seats	P.T.F.E.		
5	O-Ring	NBR		
6	Stem	Brass	CW614N	
7	Lever	Aluminium		Red
8	Screw	Steel		Zinc-plated

### Connections

ISO 228/1, ANSI B1.20.1 (NPT)

### Limit

-20°C (without liquid) +110°C

### Notes

The max.working pressure (PN) means at a room temperature of about 23°C.

## Pressure Loss Chart

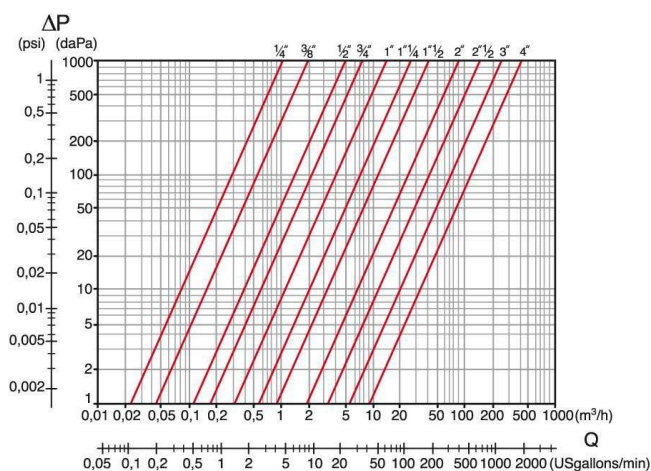

## Temperature/Pressure

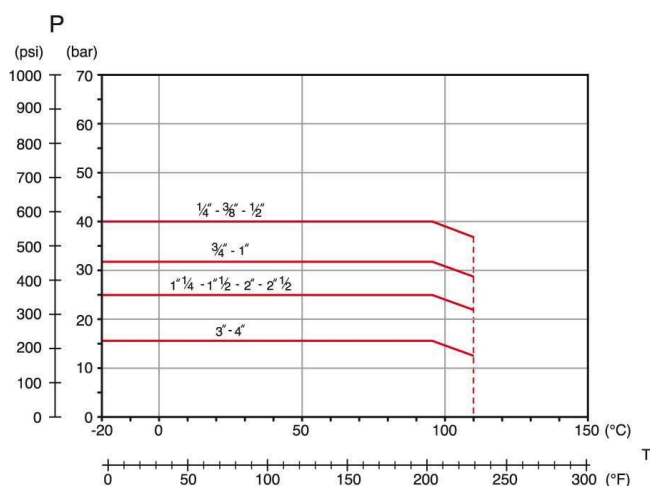

## Kv & Cv Coefficients

Size	Kv	Cv
1/4"	3,6	4,2
3/8"	6,6	76,0
1/2"	16,5	19,1
3/4"	25,0	29,0
1"	46,0	53,0
1"1/4	87,0	101,0
1"1/2	140,0	162,0
2"	275,0	318,0
2"1/2	500,0	578,0
3"	850,0	983,0
4"	1350,0	1562,0

## Approvals



RIV Rubinetterie Italiane Velatta S.p.A. - Via delle Acacie, 8 Zona Industriale D4 - 28075 GRIGNASCO (NO) - ITALY  
Tel +39 0163 4151 Fax +39 0163 411914 E-mail riv-vg@riv-vg.com Web www.riv-vg.com

Capitale sociale € 516.000 i.v. - Reg. Imprese di Novara N° 00469610026 - R.E.A. di Novara N° 170397  
Numero Meccanografico NO009263 - Codice Fiscale: 00469610026 - Partita IVA: IT 01399720034

